

RESOURCE SAVER™ ELECTRIC AND GAS DRYERS

Use & Care Guide

For questions about features, operation/performance, parts, accessories or service, call: 1-800-253-1301

or visit our website at...www.whirlpool.com

Table of Contents.....	2
------------------------	---

TABLE OF CONTENTS

DRYER SAFETY	3
PARTS AND FEATURES	5
CHECKING YOUR VENT	6
USING YOUR DRYER	7
Starting Your Dryer.....	7
Stopping and Restarting	7
Loading Clothes	8
Drying, Cycle and Temperature Tips	8
CYCLE DESCRIPTIONS	8
ACCUDRY™ Automatic Drying Cycle.....	8
Timed Drying Cycle.....	9
Temperature Settings.....	9
Additional Features	10
Drying Rack (Optional purchase)	10
CARING FOR YOUR DRYER	11
Cleaning the Lint Screen.....	11
Cleaning the Dryer Interior	11
Removing Accumulated Lint from Inside the Dryer Cabinet.....	11
Changing the Drum Light.....	11
TROUBLESHOOTING	12
ASSISTANCE OR SERVICE	13
WARRANTY	15

DRYER SAFETY

Your safety and the safety of others are very important.

We have provided many important safety messages in this manual and on your appliance. Always read and obey all safety messages.



This is the safety alert symbol.

This symbol alerts you to potential hazards that can kill or hurt you and others.

All safety messages will follow the safety alert symbol and either the word "DANGER" or "WARNING." These words mean:

! DANGER

You can be killed or seriously injured if you don't immediately follow instructions.

! WARNING

You can be killed or seriously injured if you don't follow instructions.

All safety messages will tell you what the potential hazard is, tell you how to reduce the chance of injury, and tell you what can happen if the instructions are not followed.

WARNING: For your safety, the information in this manual must be followed to minimize the risk of fire or explosion, or to prevent property damage, personal injury, or death.

- Do not store or use gasoline or other flammable vapors and liquids in the vicinity of this or any other appliance.
- **WHAT TO DO IF YOU SMELL GAS:**
 - Do not try to light any appliance.
 - Do not touch any electrical switch; do not use any phone in your building.
 - Clear the room, building, or area of all occupants.
 - Immediately call your gas supplier from a neighbor's phone. Follow the gas supplier's instructions.
 - If you cannot reach your gas supplier, call the fire department.
- Installation and service must be performed by a qualified installer, service agency, or the gas supplier.

IMPORTANT SAFETY INSTRUCTIONS

WARNING: To reduce the risk of fire, electric shock, or injury to persons when using the dryer, follow basic precautions, including the following:

- Read all instructions before using the dryer.
- Do not place items exposed to cooking oils in your dryer. Items contaminated with cooking oils may contribute to a chemical reaction that could cause a load to catch fire.
- Do not dry articles that have been previously cleaned in, washed in, soaked in, or spotted with gasoline, dry-cleaning solvents, other flammable, or explosive substances as they give off vapors that could ignite or explode.
- Do not allow children to play on or in the dryer. Close supervision of children is necessary when the dryer is used near children.
- Before the dryer is removed from service or discarded, remove the door to the drying compartment.
- Do not reach into the dryer if the drum is moving.
- Do not install or store the dryer where it will be exposed to the weather.
- Do not tamper with controls.
- Do not repair or replace any part of the dryer or attempt any servicing unless specifically recommended in this Use and Care Guide or in published user-repair instructions that you understand and have the skills to carry out.
- Do not use fabric softeners or products to eliminate static unless recommended by the manufacturer of the fabric softener or product.
- Do not use heat to dry articles containing foam rubber or similarly textured rubber-like materials.
- Clean lint screen before or after each load.
- Keep area around the exhaust opening and adjacent surrounding areas free from the accumulation of lint, dust, and dirt.
- The interior of the dryer and exhaust vent should be cleaned periodically by qualified service personnel.
- See Installation Instructions for grounding requirements.

SAVE THESE INSTRUCTIONS

PARTS AND FEATURES

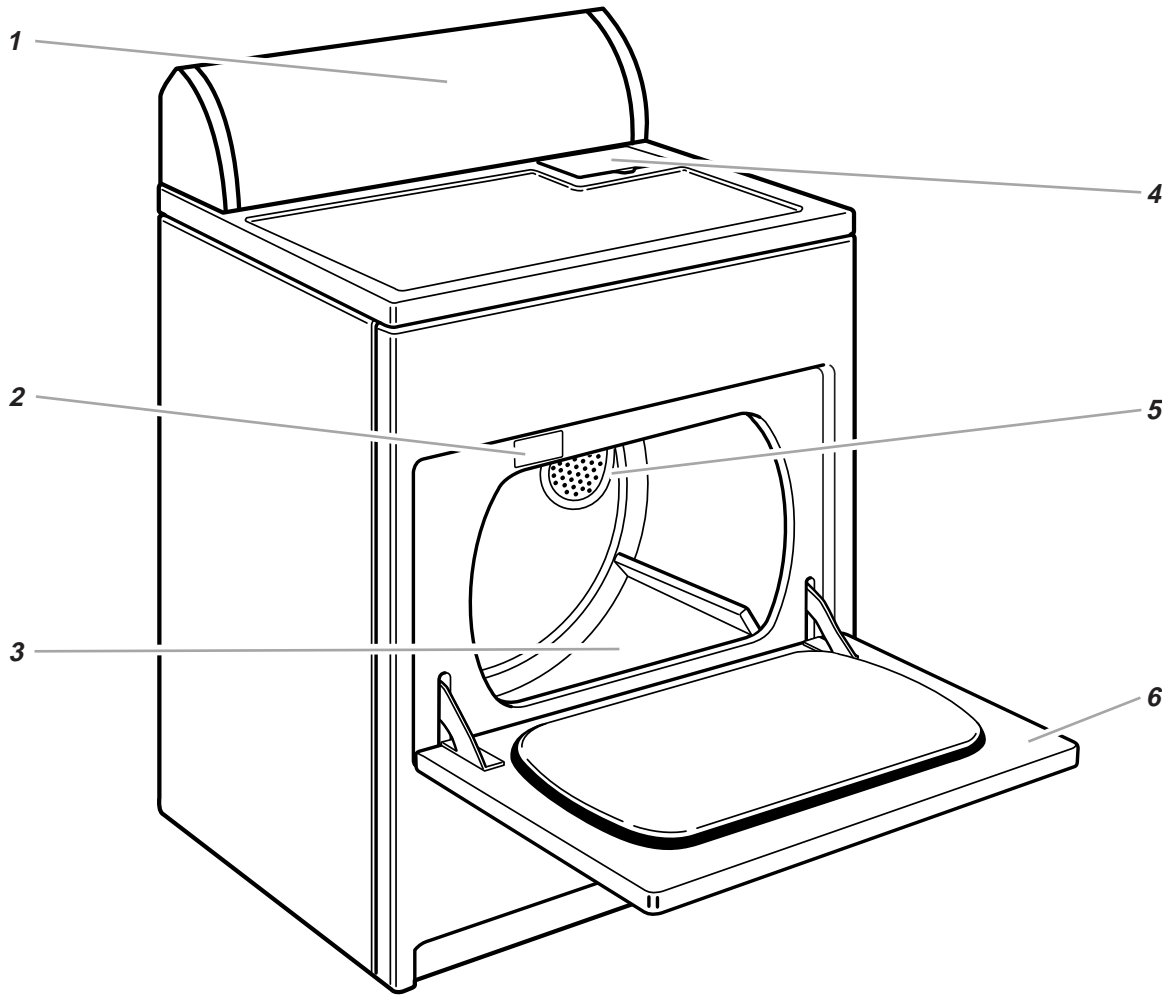

1. Control panel
2. Model and serial number label
3. Dryer drum
4. Lint screen
5. Exhaust grill
6. Wide-opening door

Additional features

ACCUDRY™ sensor drying
WRINKLE SHIELD™ Plus selector
SENSEON™ electronic sensor
RESOURCE SAVER™ setting
End of Cycle Signal selector
Drum light

Optional purchase

Drying rack

CHECKING YOUR VENT

Your dryer must be properly installed and vented to achieve maximum drying efficiency and shorten drying times. Use the minimum recommended installation clearances (found in your Installation Instructions) to avoid blocking the flow of combustion and ventilation air. Refer to your Installation Instructions for more information.

! WARNING



Fire Hazard

Use a heavy metal vent.

Do not use a plastic vent.

Do not use a metal foil vent.

Failure to follow these instructions can result in death or fire.

If the dryer is not properly installed and vented, it will not be covered under the warranty.

NOTE: Service calls caused by improper venting will be paid for by the customer, whether it was a paid installation or self-installed.

1. **Do not** use plastic vent or metal foil vent. Use 4 in. (10.2 cm) metal or flexible metal vent. Do not kink or crush flexible metal vent. It must be completely extended to allow adequate exhaust air to flow. Check vent after installation. Refer to your Installation Instructions for proper length requirements of vent.

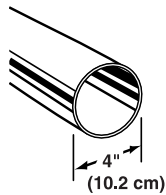

2. Use a 4 in. (10.2 cm) exhaust hood. Smaller hoods increase drying times.

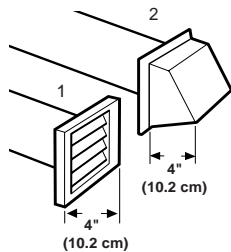

3. The exhaust vent can be routed up, down, left, right, or straight out the back of the dryer. Space requirements are listed in your Installation Instructions.

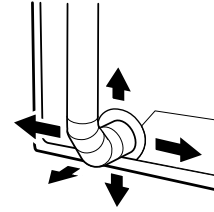

4. Use the straightest path possible when routing the exhaust vent. Use the fewest number of elbows and turns. Allow room when using elbows or making turns. Bend vent gradually to avoid kinking.

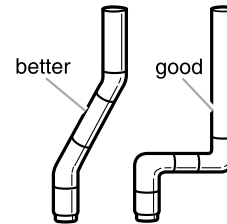

5. Use duct tape to seal all joints. **Do not** use screws to secure vent. Lint may catch on screws.

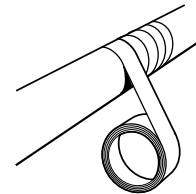

6. Clean exhaust vent periodically, depending on use, but at least every 2 years, or when installing your dryer in a new location.

- Disconnect vent from the dryer and clean one section at a time until you reach the exhaust hood.

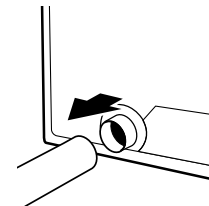

- To clean out lint, use the hose attachment on your vacuum, or a pole or wire with a feather duster or rag attached.
- Be sure the flapper on the outside end of vent moves freely.
- When cleaning is complete, be sure to follow the Installation Instructions supplied with your dryer for final product check.

USING YOUR DRYER

! WARNING



Explosion Hazard

Keep flammable materials and vapors, such as gasoline, away from dryer.

Do not dry anything that has ever had anything flammable on it (even after washing).

Failure to follow these instructions can result in death, explosion, or fire.

! WARNING



Fire Hazard

No washer can completely remove oil.

Do not dry anything that has ever had any type of oil on it (including cooking oils).

Items containing foam, rubber, or plastic must be dried on a clothesline or by using an Air Cycle.

Failure to follow these instructions can result in death or fire.

Starting Your Dryer

Before using your dryer, wipe the dryer drum with a damp cloth to remove dust from storing and shipping. The following steps provide an overview for operating your dryer. Specific directions for each step are provided in the following sections.

1. Load clothes loosely into the dryer and close the door. Do not pack the dryer. Allow space for clothes to tumble freely.



2. Turn the Cycle Control knob to the recommended cycle for the type of load being dried. Use the Energy Preferred Automatic Setting (*) to dry most loads. See "Drying, Cycle and Temperature Tips."

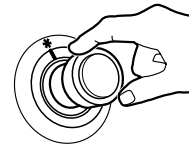

3. Select a Temperature setting. See "Temperature Settings."
4. (OPTIONAL STEP) Set the WRINKLE SHIELD™ Plus feature selector to the desired setting. See "Additional Features."
5. (OPTIONAL STEP) Set the End of Cycle Signal to the desired setting. The signal is helpful when drying permanent press or synthetics. Promptly remove these items from the dryer at the end of the cycle to prevent wrinkles.
6. Push the START button.

Stopping and Restarting

You can stop your dryer any time during a cycle.

To stop your dryer

Open the dryer door or turn the Cycle Control knob to OFF.

NOTE: The Cycle Control knob should point to an Off area when the dryer is not in use.

To restart your dryer

1. Close the door.
2. Select a new cycle and temperature (if desired).
3. Push START.

Loading Clothes

Load clothes loosely into the dryer. Do not pack the dryer. Allow space for clothes to tumble freely. The following chart shows examples of balanced loads that would allow for proper tumbling.

Heavy work clothes	3 pair of pants, 4 pair of jeans, 2 pair of overalls, 3 shirts
Delicates	3 camisoles, 1 robe, 4 slips, 6 undergarments, 2 sets of sleepwear, 1 child's outfit
Towels	10 bath towels, 10 hand towels, 14 wash cloths, 1 bath mat
Mixed Load	3 double sheets, 4 pillowcases, 8 T-shirts, 6 pair of shorts, 2 blouses, 8 handkerchiefs

Drying, Cycle and Temperature Tips

Select the correct cycle and temperature for your load.

Cool Down tumbles the load without heat during the last few minutes of all cycles to make the load easier to handle.

Drying tips

- Always follow care label directions when they are available.
- If you use fabric softener sheets, use only ones labeled as dryer safe. Follow package instructions.
- Remove the load from the dryer as soon as tumbling stops to reduce wrinkling. This is especially important for permanent press, knits, and synthetic fabrics.

Cycle tips

- Use the Energy Preferred Automatic Setting (*) with the RESOURCE SAVER™ temperature setting to save the most energy while drying average size loads of lightweight to medium weight items.
- Use the Very Dry setting with the RESOURCE SAVER temperature setting to save energy while drying larger loads of medium weight to heavyweight items.

Temperature tips

- Use a High heat setting for drying heavyweight items such as towels and work clothes.
- Use a Medium heat setting for drying medium weight items such as sheets, underwear, permanent press fabrics, and some knits.
- Use a Low heat setting for drying lightweight items such as lingerie, blouses, dresses, and some knits.
- Use a no heat (air) setting for rubber, plastic or special care fabrics.
- Line dry bonded or laminated fabrics.

If you are unsure of the temperature to select for a load, select the lower setting rather than the higher setting.

NOTE: If you have questions about drying temperatures for various loads, refer to the care label directions.

CYCLE DESCRIPTIONS

Your new RESOURCE SAVER™ dryer uses the Temperature selector with the Cycle Control knob to design a drying cycle to provide the shortest, most efficient drying time and best fabric care for your load.

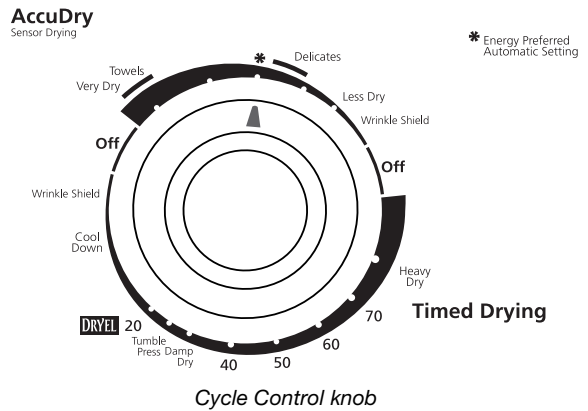

ACCUDRY™ Automatic Drying Cycle

The automatic cycle uses the ACCUDRY™ electronic control sensor that senses the moisture in your load and shuts off the dryer when the selected dryness is reached. The Cycle Control knob does not move until the load is almost dry. After the cool down, the knob automatically turns to an Off area and tumbling stops.

Your most frequently used Temperature settings, Normal and High, when used with the automatic cycle, are enhanced with the SENSEON™ drying system to provide the shortest drying time. See "Temperature Settings."

Dry most loads using the Energy Preferred Automatic Setting (*).

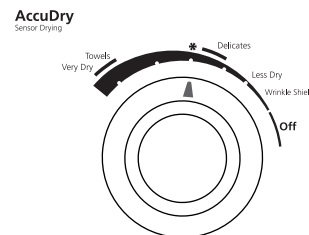

- If the load is drier than you like, select a setting closer to Less Dry the next time you dry a similar load.
- If the load is not as dry as you like, complete drying using the Timed Drying cycle. The next time you dry a similar load, select a setting closer to Very Dry.

Towels

Use this setting to thoroughly dry extra heavy items, such as mattress pads, quilts or towels. Set the Temperature selector at High heat.

Delicates

Use this setting to dry small loads or lightweight items. Set the Temperature selector at Low or Extra Low heat.

NOTE: Drying time with an automatic cycle varies according to the type of fabric, size of load, and temperature setting. See "Drying, Cycle and Temperature Tips."

Timed Drying Cycle

Use the Timed Drying cycle to complete drying if items are still damp after the automatic cycle.

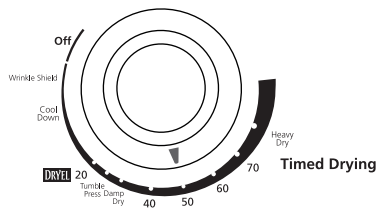

Timed Drying is also useful for:

- Heavyweight and bulky items, such as bedspreads and work clothes and large loads that require a long drying time. Set the Temperature selector to a heat setting that matches the care label directions.
- Lightweight items, such as lingerie, blouses, and knits that require a short drying time. Set the Temperature selector at Low or Ex-Low heat.

Heavy Dry

Use this setting to thoroughly dry large or heavy items, such as thick bath towels or robes. Set the Temperature selector at High heat.

DRYEL® fabric care system

When using DRYEL fabric care, select the DRYEL cycle setting and the DRYEL temperature setting. DRYEL fabric care, when used in accordance with the manufacturer's directions, has been tested and approved for use in full-size dryers built by Whirlpool Corporation.

Damp Dry

Use this setting to dry items to damp level or to dry items that do not require an entire drying cycle. Damp dry items such as jeans (to prevent stiffness) or cotton clothes (to make pressing easier). set the Temperature selector at High heat.

TUMBLE PRESS® setting

Use this setting to remove wrinkles from items, such as clothes packed in a suitcase or items wrinkled from being left in the dryer too long. Set the Temperature selector at Low or Medium heat, depending on the fabrics in your load.

Temperature Settings

The Temperature selector allows you to select a drying temperature that matches the fabrics in your load and provides for shortest, most efficient drying time..

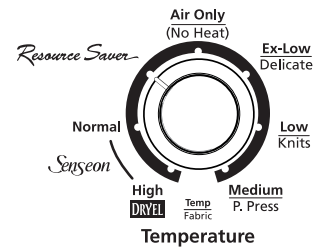

RESOURCE SAVER™ setting

The RESOURCE SAVER temperature setting saves energy by using electronic sensors to carefully monitor and regulate the amount of heat inside the dryer. When used with the ACCUDRY™ automatic drying cycle (see "ACCUDRY™ Automatic Drying Cycle"), the RESOURCE SAVER setting provides the best drying efficiency while saving energy.

- Use the RESOURCE SAVER setting with the Energy Preferred Automatic Setting (*) to save the most energy when drying an average size load of lightweight to medium weight items, such as sheets, shirts and dresses.
- Use the RESOURCE SAVER setting with the Very Dry cycle to save energy when drying a large load of medium weight to heavyweight items, such as work clothes or cotton jerseys.
- We do not recommend use of the RESOURCE SAVER setting when drying large loads of extra heavy or bulky items, such as jeans, thick cotton towels, or quilts. To thoroughly dry these heavyweight items, select a High heat setting.

NOTE: The energy-saving feature of the RESOURCE SAVER setting is not as effective when using the Timed Drying cycle.

SENSEON™ Drying System

The SENSEON drying system uses electronic sensors to detect the size and types of fabrics in your load to provide the shortest drying time. When used with the ACCUDRY™ automatic drying cycle (see "ACCUDRY™ Automatic Drying Cycle"), the SENSEON setting provides the shortest drying time and best fabric care for your load.

- The Normal setting, when used with the Energy Preferred Automatic Setting (*), provides medium heat to evenly dry sturdy casual clothes, such as khakis and cotton jerseys, in the shortest time. When used with the Timed Drying cycle, Normal provides medium heat for your selected drying time.
- The High setting, when used with the Energy Preferred Automatic Setting (*), provides high heat to thoroughly dry heavyweight items, such as jeans, corduroys or work clothes, in the shortest time. When used with the Timed Drying cycle, High provides high heat for your selected drying time.

Medium/Permanent Press

Select this medium temperature setting to dry lightweight to medium weight to synthetic or no-iron items, such as sheets, shirts or dresses.

Low/Knits

Select this low temperature setting to gently dry washable knit items, such as blouses, sweaters and lingerie.

Extra Low/Delicate

Select this extra low temperature setting to gently dry special care items, such as exercise wear, sheer curtains or lace.

Air Only (No Heat)

Use this unheated temperature setting for items that require drying without heat, such as rubber, plastic and sheer fabrics. When using Air Only, select a drying time with the Timed Drying cycle.

This chart shows examples of items that can be dried using the Air Only setting.

Type of Load	Air Only setting* (minutes)
Foam rubber - pillows, padded bras, stuffed toys	20 - 30
Plastic - shower curtains, tablecloths	20 - 30
Rubber-backed rugs	40 - 50
Olefin, polypropylene, sheer nylon	10 - 20

*Reset cycle to complete drying, if needed.

When using Air Only

- Check to see that coverings are securely stitched.
- Shake and fluff pillows by hand periodically during cycle.
- Dry item completely. Foam rubber pillows are slow to dry.

Additional Features

You can select one of the following options to help ensure the best fabric care for your load.

WRINKLE SHIELD™ Plus setting

When you are unable to remove a load of clothes from the dryer as soon as it stops, wrinkles can form. The WRINKLE SHIELD Plus setting periodically tumbles, rearranges and fluffs the load to avoid wrinkles.

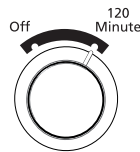

Wrinkle Shield Plus

The WRINKLE SHIELD Plus setting periodically tumbles the load without heat for up to 120 minutes. A signal will sound periodically when WRINKLE SHIELD Plus is on, if the End of Cycle Signal is selected. The signal and the cycle will end when you open the dryer door, or turn the Cycle Control knob to Off.

End of Cycle Signal

If the End of Cycle Signal is selected, the signal sounds when a cycle is complete. If WRINKLE SHIELD™ Plus feature is selected, the signal sounds every few minutes. The signal stops when you open the door.

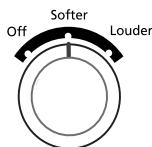

End of Cycle Signal

Turn the knob to select a Softer or Louder signal or to turn the End of Cycle Signal Off.

Drying Rack (Optional purchase)

You can order a drying rack by calling **1-800-442-9991** or by contacting the dealer from whom you purchased your dryer.

The rack is useful for machine drying items you would not necessarily want to tumble dry (for example, sweaters).

To use the drying rack

1. Slide rear pegs into the dimples on the back wall of the dryer. Lower the front legs to rest on the dryer opening.

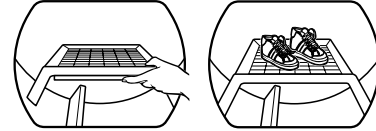

2. Put the wet items on top of the rack. Leave space between the items so air can reach all the surfaces. Close the door.

NOTE: Do not allow items to hang over the edge of the rack.

3. Select the Timed Drying cycle and the Air Only temperature setting. Items containing foam, rubber, or plastic must be dried on a clothesline or by using an air cycle.

4. Push the START button.

NOTE: You must remove rack for normal tumbling. Do not use the automatic cycle with the drying rack.

This chart shows examples of items that can be rack dried and the suggested cycle, temperature setting and drying time. Actual drying time will depend on the amount of moisture items hold.

Rack Dry	Cycle	Temp	Time*
Wool Sweaters Block to shape and lay flat on the rack	Timed Drying	Low	60
Stuffed toys or pillows Cotton or polyester fiber filled	Timed Drying	Low	60
Stuffed toys or pillows Foam rubber filled	Timed Drying	Air Only	90
Sneakers or canvas shoes	Timed Drying	Air Only	90

*(Minutes). Reset cycle to complete drying, if needed.

CARING FOR YOUR DRYER

Cleaning the Lint Screen

Every load cleaning

The lint screen is located on the top of the dryer. Clean it before each load. A screen blocked by lint can increase drying time.

To clean

1. Pull the lint screen towards you. Roll lint off the screen with your fingers. Do not rinse or wash screen to remove lint. Wet lint is hard to remove.

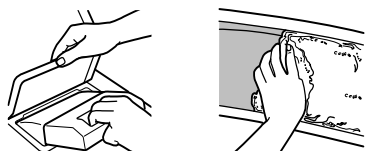

2. Push the lint screen firmly back into place.

IMPORTANT:

- Do not run the dryer with the lint screen loose, damaged, blocked, or missing. Doing so can cause overheating and damage to both the dryer and fabrics.
- Some towels made of synthetic fibers and natural fibers (polyester and cotton blends) may shed more lint than other towels, causing your dryer's lint screen to fill up faster. Be sure to remove lint from the lint screen before and after drying new towels.
- If lint falls off the screen into the dryer during removal, check the exhaust hood and remove the lint. See "Checking Your Vent."

As needed cleaning

Laundry detergent and fabric softener residue can build up on the lint screen. This buildup can cause longer drying times for your clothes, or cause the dryer to stop before your load is completely dry. The screen is probably clogged if lint falls off the screen.

Clean the lint screen with a nylon brush every six months or more frequently if it becomes clogged due to a residue buildup.

To wash

1. Wet both sides of lint screen with hot water.
2. Wet a nylon brush with hot water and liquid detergent. Scrub lint screen with the brush to remove residue buildup.

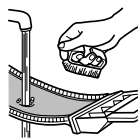

3. Rinse screen with hot water.
4. **Thoroughly** dry lint screen with a clean towel. Replace screen in dryer.

Cleaning the Dryer Interior

! WARNING



Explosion Hazard

Use nonflammable cleaner.

Failure to do so can result in death, explosion, or fire.

To clean dryer drum

1. Make a paste with powdered laundry detergent and very warm water.
2. Apply paste to a soft cloth.

OR

Apply a liquid, non-flammable household cleaner to the stained area and rub with a soft cloth until all excess dye is removed.

3. Wipe drum thoroughly with a damp cloth.
4. Tumble a load of clean cloths or towels to dry drum.

NOTE: Garments which contain unstable dyes, such as denim blue jeans or brightly colored cotton items, may discolor the dryer interior. These stains are not harmful to your dryer and will not stain future loads of clothes. Dry unstable dye items inside out to prevent dye transfer.

Removing Accumulated Lint from Inside the Dryer Cabinet

Lint should be removed every two years, or more often, depending on dryer usage. Cleaning should be done by a qualified person.

Changing the Drum Light

If your dryer has a drum light, the dryer light automatically turns on inside the dryer drum when you open the door.

To change the drum light

1. Unplug dryer or disconnect power.
2. Open the dryer door. Locate the light bulb cover on the back wall of the dryer. Remove the screw located in the lower right corner of the cover. Remove the cover.

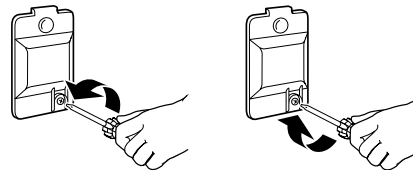

3. Turn bulb counterclockwise. Replace the bulb with a 10-watt appliance bulb only. Replace the cover.
4. Plug in dryer or reconnect power.

TROUBLESHOOTING

First try the solutions suggested here and possibly avoid the cost of a service call...

Clothes are not drying satisfactorily

- **Check the following:**
 - Is the lint screen clogged with lint?

Is the exhaust vent or outside exhaust hood clogged with lint, restricting air movement? Run the dryer for 5-10 minutes. Hold your hand under the outside exhaust hood to check air movement. If you do not feel air movement, clean exhaust system of lint or replace exhaust vent with heavy metal or flexible metal vent. See your Installation Instructions.

Is the exhaust vent crushed or kinked? Replace with heavy metal or flexible metal vent. See your Installation Instructions.

Has a fuse blown, or a circuit breaker tripped? Electric dryers use 2 household fuses or breakers. The drum may be turning but you may not have heat.

Has an air dry cycle been selected? Select the right cycle for the types of garments being dried. See "Drying, Cycle and Temperature Tips."

For gas dryers, is the valve open on the supply line?

Are fabric softener sheets blocking the grill? Use only one fabric softener sheet and only use it once.

Is the RESOURCE SAVER™ setting selected? Heavy or large loads may require a cycle setting closer to Very Dry in the automatic cycles, or the Timed Dry cycle and a High heat temperature setting, to dry satisfactorily.
- **Is the dryer located in a room with temperature below 45°F (7°C)?**

Proper operation of dryer cycles requires temperatures above 45°F (7°C).
- **Was a cold rinse water used? Was the load very wet?**

Expect longer drying times with items rinsed in cold water and with items that hold moisture (cottons).
- **Is the load too large and heavy to dry quickly?**

Separate the load to tumble freely.

Dryer will not run

- **Check the following:**
 - Is the power cord plugged in?
 - Has a fuse blown, or has circuit breaker tripped?
 - Was a regular fuse used? Use a time-delay fuse.
 - Is the dryer door firmly closed?
 - Was the START button firmly pressed?
 - Is a cycle selected?

Unusual sounds

- **Has the dryer had a period of non-use?**

If the dryer hasn't been used for a while, there may be a thumping sound during the first few minutes of operation.
- **Is it a gas dryer?**

The gas valve clicking is a normal operating sound.
- **Is the RESOURCE SAVER setting selected?**

To save energy, a gas dryer operating with the RESOURCE SAVER setting selected cycles on and off more often. This results in a clicking sound.

Lint on load

- **Is the lint screen clogged?**

Clean lint screen. Check for air movement.
- **Is the load properly sorted?**

Sort lint givers (towels, chenille) from lint takers (corduroy, synthetics). Also sort by color.
- **Is the load too big or too heavy?**

Dry smaller loads so lint can be carried to the lint screen.
- **Was the load overdried?**

Use correct dryer settings for load type. See "Drying, Cycle and Temperature Tips". Overdrying can cause lint-attracting static electricity.
- **Was paper or tissue left in pockets?**

Clean out pockets before drying.
- **Is pilling being mistaken for lint?**

Pilling (surface fuzz) is caused by normal wear and laundering.

Stains on load or color change

- **Was dryer fabric softener properly used?**

Add dryer fabric softener sheets at the beginning of the cycle. Fabric softener sheets added to a partially-dried load can stain garments.
- **Were items soiled when placed in the dryer?**

Items should be clean before being dried.
- **Were items properly sorted?**

Sort light colors from dark colors. Sort colorfast items from noncolorfast items.

Items shrinking

- **Was the dryer overloaded?**

Dry smaller loads that can tumble freely.
- **Did the load overdry?**

Check the manufacturer's care label. Match dryer setting to load type. See "Drying, Cycle and Temperature Tips."

Loads are wrinkled

- **Was the load removed from dryer at the end of the cycle?**

Remove load as soon as tumbling stops.
- **Was the dryer overloaded?**

Dry smaller loads that can tumble freely.
- **Did the load overdry?**

Check the manufacturer's care label. Match dryer setting to load type. See "Drying, Cycle and Temperature Tips."

Odors

- **If the dryer is electric, is it being used for the first time?**
The new electric heating element may have an odor. The odor will be gone after the first cycle.
- **If the dryer is gas, there may be a gas leak:**
Turn off the gas supply line, leave your house and then call your local gas company.
- **Have you recently been painting, staining or varnishing in the area where your dryer is located?**
If so, ventilate the area. When the odors or fumes are gone from the area, re-wash and dry the clothing.

Garment damage

- **Check the following:**
Were zippers, snaps, and hooks left open?
Were strings and sashes tied to prevent tangling?
Were care label instructions followed?
Were items damaged before drying?

ASSISTANCE OR SERVICE

Before calling for assistance or service, please check "Troubleshooting." It may save you the cost of a service call. If you still need help, follow the instructions below.

When calling, please know the purchase date and the complete model and serial number of your appliance. This information will help us to better respond to your request.

If you need replacement parts

If you need to order replacement parts, we recommend that you only use FSP® factory specified parts. These parts will fit right and work right because they are made with the same precision used to build every new WHIRLPOOL GOLD® appliance. To locate factory specified replacement parts in your area, call our Customer Interaction Center at **1-800-253-1301**, or your nearest designated service center.

For assistance

Call the Whirlpool Customer Interaction Center toll free: **1-800-253-1301**.

Our consultants provide assistance with:

- Features and specifications on our full line of appliances
- Installation information
- Use and maintenance procedures
- Accessory and repair parts sales
- Specialized customer assistance (Spanish speaking, hearing impaired, limited vision, etc.)
- Referrals to local dealers, repair parts distributors, and service companies. Whirlpool designated service technicians are trained to fulfill the product warranty and provide after-warranty service, anywhere in the United States.

To locate the Whirlpool designated service company in your area, you can also look in your telephone directory Yellow Pages.

For further assistance

If you need further assistance, you can write to Whirlpool Corporation with any questions or concerns at:

Whirlpool Corporation
Customer Interaction Center
553 Benson Road
Benton Harbor, MI 49022-2692

Please include a daytime phone number in your correspondence.

WHIRLPOOL GOLD® DRYER WARRANTY

ONE-YEAR FULL WARRANTY

For one year from the date of purchase, when this dryer is operated and maintained according to instructions attached to or furnished with the product, Whirlpool Corporation will pay for FSP® replacement parts and repair labor to correct defects in materials or workmanship. Service must be provided by a Whirlpool designated service company.

Whirlpool Corporation will not pay for:

1. Service calls to correct the installation of your dryer, including venting. Heavy 4 in. (10.2 cm) metal exhaust vent must be used. Refer to the venting section of this manual and your Installation Instructions.
 2. Service calls to instruct you how to use your dryer, to replace house fuses or correct house wiring or reset circuit breakers, or to replace owner accessible light bulbs.
 3. Repairs when your dryer is used in other than normal, single-family household use.
 4. Damage resulting from accident, alteration, misuse, abuse, fire, floods, acts of God, improper installation (including, but not limited to, venting with plastic or flexible foil), installation not in accordance with local electrical and plumbing codes, or use of products not approved by Whirlpool Corporation.
 5. Replacement parts or repair labor costs for units operated outside the United States.
 6. Pickup and delivery. This product is designed to be repaired in the home.
 7. Repairs to parts or systems resulting from unauthorized modifications made to the appliance.
-

WHIRLPOOL CORPORATION SHALL NOT BE LIABLE FOR INCIDENTAL OR CONSEQUENTIAL DAMAGES.

Some states do not allow the exclusion or limitation of incidental or consequential damages, so this exclusion or limitation may not apply to you. This warranty gives you specific legal rights and you may also have other rights which vary from state to state.

Outside the 50 United States, this warranty does not apply. Contact your authorized Whirlpool dealer to determine if another warranty applies.

If you need service, first see "Troubleshooting." Additional help can be found by checking "Assistance or Service," or by calling our Customer Interaction Center at **1-800-253-1301**, from anywhere in the U.S.A. or write: Whirlpool Corporation, Customer Interaction Center, 553 Benson Road, Benton Harbor, MI 49022-2692.

3/00

Keep this book and your sales slip together for future reference. You must provide proof of purchase or installation date for in-warranty service.

Write down the following information about your dryer to better help you obtain assistance or service if you ever need it. You will need to know your complete model number and serial number. You can find this information on the model and serial number label/plate, located on your appliance as shown in "Parts and Features."

Dealer name _____
Address _____
Phone number _____
Model number _____
Serial number _____
Purchase date _____